

O.L. Seals A/S

# Flange Seals

MupuSeal® Type 3052-

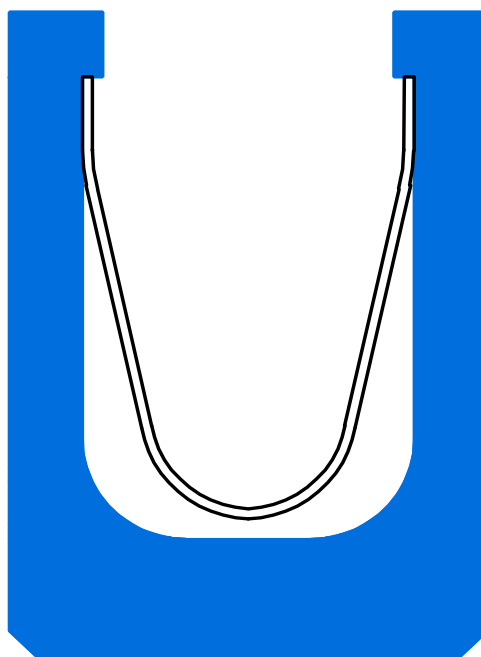

Spring energized flange seal for external pressure



### MupuSeal® Type 3052-

Is a spring energized flange seal for external pressure and dynamic applications. MupuSeal® consists of a jacket of Kefloy® energized by a V-shaped corrosion resistant steel spring.

The steel spring is available in three different chemical resistant alloys.

- Stainless steel                   AISI 301; DIN 1.4310
- Hasteloy® C-276               EN ISO 15156; NACE MR-01-75
- Elgiloy®                         ASTM F1058; EN ISO 15156; NACE MR-01-75

Hasteloy® is a trademark of Haynes International Inc.  
Elgiloy® is a registered trademark of Elgiloy Specialty Metals

The flexible V-spring gives a good spring force which ensures the sealing capacity. MupuSeal® is designed for dynamic applications at moderate speeds. MupuSeal® can be used with virtually all fluids.  
MupuSeal® is pressure responsive.



### Working Range

#### Pressure

Up to 45 MPa in standard execution. For pressures exceeding 45 MPa, please contact your O.L. Seals distributor.

#### Temperature

-70°C to + 260°C. For temperatures exceeding this temperature range, please contact your O.L. Seals distributor.

#### Velocity

Rotating speed up to 2 m/sec.

#### Fluids

Kefloy® is compatible with virtually all fluids – liquids as well as gases. By selecting the right alloy for the spring energizer, it is possible to cover almost all fluids.

### Applications

Due to its unique properties MupuSeal® is used in a great variety of applications

- Extreme temperatures
- Aggressive environments
- Food and drug
- Offshore
- Chemical processes
- Refrigeration
- Energy
- Electronic
- Machine tools
- Aviation
- Defence



## Advantages

- Very good sealing efficiency
- Compatible with virtually all fluids
- Covers a very big thermal range
- No contamination of fluids
- Can be sterilised
- No ageing
- No vulcanisation to mating surface
- Unlimited shelf life
- Simple groove design
- NACE compatible spring alloys available
- Available for all diameters up to 2.500 mm

## Material Selection Guide

Fluid	Mating surface	MupuSeal® compound
Water	Steel	Kefloy® 11
Water hydraulic	Chrome plated steel	Kefloy® 25
Steam	Cast iron	Kefloy® 28
Non lubricating fluids	Aluminium	Kefloy® 40
Air, dry or lubricated	Stainless steel	Kefloy® 90
	Bronze	
	Soft metals	
Hydraulic oil	Steel	Kefloy® 11
Motor oil	Chrome plated steel	Kefloy® 13
Grease	Cast iron	Kefloy® 28
Other mineral oils		Kefloy® 90
	Aluminium	Kefloy® 11
	Stainless steel	Kefloy® 25
	Bronze	Kefloy® 28
	Soft metals	Kefloy® 40
		Kefloy® 90

*For other fluids or sealing surfaces, please consult your O.L. Seals distributor.*



## Seal Selection Guide

### Ordering Example

Groove inner diameter: 83.7 mm

Part no 30522-0837-40-S  
 MupuSeal® type \_\_\_\_\_  
 Series \_\_\_\_\_  
 Groove dia. x 10 \_\_\_\_\_  
 Jacket compound no \_\_\_\_\_  
 Spring material \_\_\_\_\_

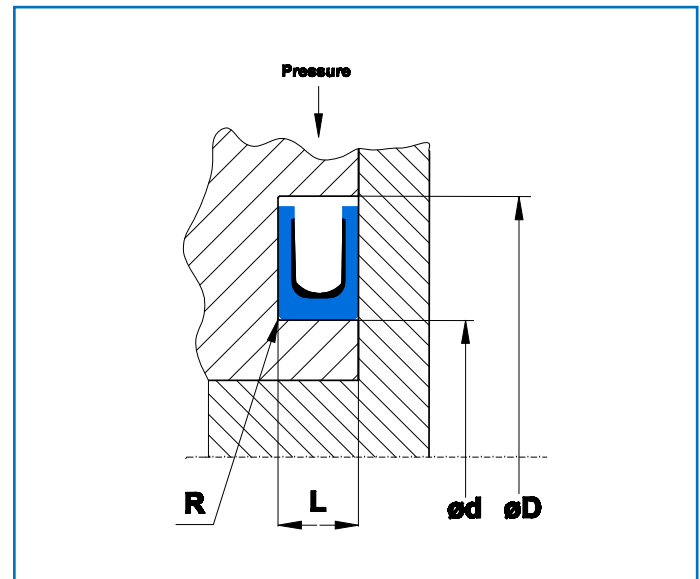

## Installation dimensions

MupuSeal Face Cross section		Inner dia. ød Groove	Outer dia. øD	Groove length L		Radius R	Recomm. dia/cross
Part no.	Series	Min. dia. h11	dia.	+0,15 -0	Toll.	Max.	
30521	100	40.0	ød+7.20	2.25	+0.05/-0	0.4	40 – 49.99
30522	200	45.0	ød+9.60	3.10	+0.08/-0	0.6	50 – 99.99
30523	300	80.0	ød+14.20	4.70	+0.10/-0	0.8	100 – 199.99
30524	400	110.0	ød+19.00	6.10	+0.15/-0	0.8	200 – 999.99
30525	500	400.0	Ød+30.00	9.50	+0.20/-0	0.8	1000 –

### Important Note

The limits of pressure, temperature and velocity are individual maximum values. Heat generated by the friction may cause local increase of temperature. The cooling possibilities for the system determines the combinations of maximum values.