

Profile Data

Piston Seal PS08A

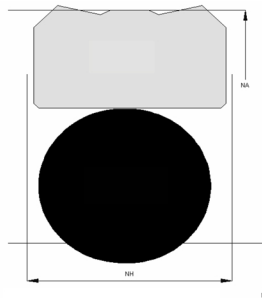

Function

Piston seals are designed to seal the pressurized hydraulic fluid against the atmosphere or between two pressurized spaces.

Features

- ⇒ Asymmetrical, double acting piston seal, designed with interference of the O-Ring on the ID and slight interference of the glide ring on the OD.
- ⇒ Two external sealing edges working as a primary seal and reducing the risk of the blow-by effect.
- ⇒ Central back-up and sealing bulge.
- ⇒ Glide ring in very wear resistant hard grade polyurethane (PU-D57).
- ⇒ Suitable for positioning and holding functions.
- ⇒ Negligible tendency to “stick-slip” effect.
- ⇒ Low break-away load after long standstills.
- ⇒ Good gap extrusion resistance.

Application

Reciprocating pistons in hydraulic cylinders, plungers.
Dynamic seals in hydraulic systems.
Max. pressure 250 bar, max. speed 1 m/s

Installation

Snap-in installation.

Seal housing data

Tolerances	[mm]	
NL < 10mm	+ 0.2	
NL ≥ 10mm	+ 0.3	
∅ NA	H 8	
∅ NI	h 8	
Surface roughness	Rtmax [μ]	Ra [μ]
Bottom of groove	≤ 6.3	≤ 1.6
Face of groove	≤ 15	≤ 3
Sliding surface	Rtmax [μ]	Ra [μ]
PU, elastomer	≤ 2.5	≤ 0.1-0.5
PTFE	≤ 2	≤ 0.05-0.3

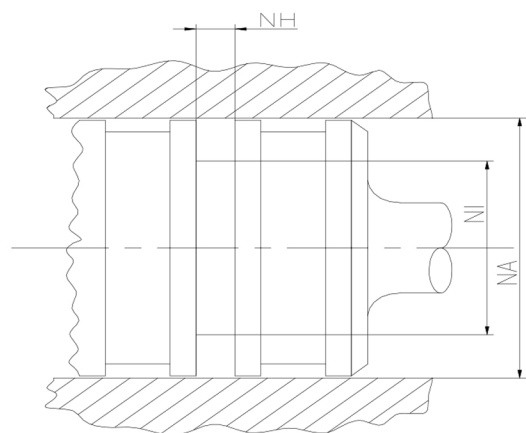

Sealco House, Maypole Fields Halesowen, West Midlands, UK, B63 2QB

T: (+44)1384 413058 E: sales@sealco.co.uk W: www.sealco.co.uk