

# Profile Data

## Rotary Seal R10A

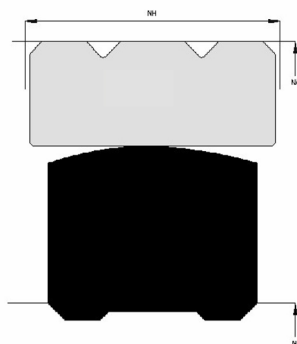

### **Function**

Rotary seals are designed to seal the pressurized hydraulic fluid against the atmosphere, preventing leakage and pollution of the environment or to transfer liquids and/or gases from a stationary part into or out of rotating machinery.

### **Features**

- ⇒ Asymmetrical, double acting rotary seal for outside sealing, designed with interference of the preload element on the ID and no interference of the PTFE glide ring on the OD.
- ⇒ Excellent sealing performance at low speeds with high pressure.
- ⇒ Peripheral grooves that enable the build up of a lubricant reservoir.
- ⇒ No tendency to “stick-slip” effect.
- ⇒ Low break-away load after long standstills.
- ⇒ Good gap extrusion resistance.
- ⇒ Especially for use in non standardized grooves.

### **Application**

Slow moving shafts, pivoting movements, revolving distributors, swivel joints.  
Max. pressure 350 bar, max. speed 0.4 m/s.

### **Installation**

Snap-in installation.

Attention: PTFE glide rings need calibration after installation!

### **Seal housing recommendation**

<b>Tolerances</b>	<b>[mm]</b>	
L < 10mm	+ 0.2	
L ≥ 10mm	+ 0.3	
∅ NA	H8	
∅ NI	f8	
<b>Surface roughness</b>	<b>Rtmax [μ]</b>	<b>Ra [μ]</b>
Bottom of groove	≤ 6.3	≤ 1.6
Face of groove	≤ 15	≤ 3
<b>Sliding surface</b>	<b>Rtmax [μ]</b>	<b>Ra [μ]</b>
PU, elastomeres	≤ 2.5	≤ 0.1-0.5
PTFE	≤ 2	≤ 0.05-0.3

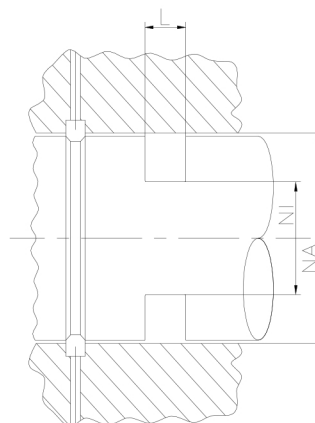

Sealco House, Maypole Fields Halesowen, West Midlands, UK, B63 2QB

T: (+44)1384 413058 E: sales@sealco.co.uk W: www.sealco.co.uk